

HEAD DIMENSIONS

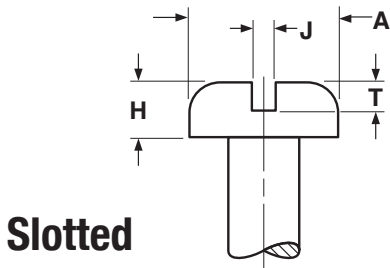

Slotted

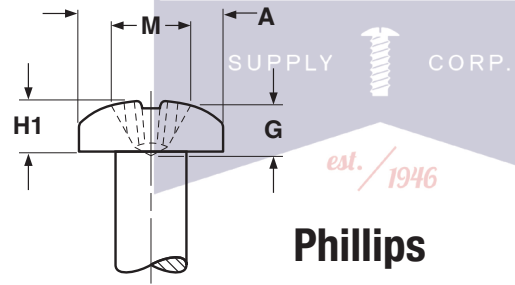

Phillips

PAN HEADS FOR MACHINE SCREWS AND SEMS

ASME B18.6.3-2010

Nominal Size	A		H		H1		J		T		M	G		Phillips Driver Size
	Head Diameter		Height of Head				Width of Slot		Depth of Slot		Diameter	Recess Penetration Gaging Depth		
			Slotted		Recessed									
	Max	Min	Max	Min	Max	Min	Max	Min	Max	Min	Ref	Max	Min	
0	.116	.104	.039	.031	.044	.036	.023	.016	.022	.014	.060	.032	.014	0
2	.167	.155	.053	.045	.062	.053	.031	.023	.031	.022	.097	.052	.034	1
3	.193	.180	.060	.051	.071	.062	.035	.027	.036	.026	.105	.061	.043	1
4	.219	.205	.068	.058	.080	.070	.039	.031	.040	.030	.115	.071	.053	1
5	.245	.231	.075	.065	.089	.079	.043	.035	.045	.034	.152	.072	.046	2
6	.270	.256	.082	.072	.097	.087	.048	.039	.050	.037	.159	.080	.055	2
8	.322	.306	.096	.085	.115	.105	.054	.045	.058	.045	.175	.097	.071	2
10	.373	.357	.110	.099	.133	.122	.060	.050	.068	.053	.192	.113	.089	2
12	.425	.407	.125	.112	.151	.139	.067	.056	.077	.061	.252	.124	.098	3
1/4	.492	.473	.144	.130	.175	.162	.075	.064	.087	.070	.274	.144	.118	3
5/16	.615	.594	.178	.162	.218	.203	.084	.072	.106	.085	.343	.173	.149	4
3/8	.740	.716	.212	.195	.261	.244	.094	.081	.124	.100	.382	.213	.190	4
1/2	.987	.958	.281	.260	.348	.325	.106	.091	.161	.131	.428	.260	.235	4

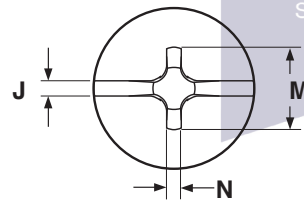
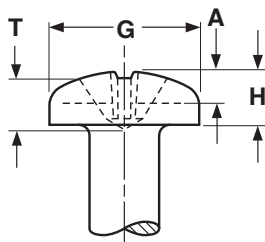

COMBINATION DRIVE PAN HEADS FOR MACHINE SCREWS

ASME B18.6.3-2010

Nominal Screw Size	G		H		J		A		M		T		N	Recess Penetration		Driver Size
	Head Dimensions		Slot Dimensions				Recess Dimensions				Recess Width					
	Head Diameter		Head Height		Width		Depth		Diameter			Depth				
	Max	Min	Max	Min	Max	Min	Max	Min	Max	Min	Max	Min	Min	Max	Min	
4	.219	.205	.080	.070	.039	.031	.040	.027	.122	.109	.078	.060	.019	.071	.053	1
6	.270	.256	.097	.087	.048	.039	.050	.033	.166	.153	.091	.066	.028	.080	.055	2
8	.322	.306	.115	.105	.054	.045	.058	.041	.182	.169	.108	.082	.030	.097	.071	2
10	.373	.357	.133	.122	.060	.050	.068	.048	.199	.186	.124	.100	.031	.113	.089	2
12	.425	.407	.151	.112	.067	.056	.077	.055	.259	.246	.141	.115	.034	.124	.098	3
1/4	.492	.473	.175	.162	.075	.064	.087	.063	.281	.268	.161	.135	.036	.144	.118	3
5/16	.615	.594	.218	.203	.084	.072	.106	.076	.350	.337	.193	.169	.059	.173	.149	4