

Light Hex,
Thin Height

NYLON INSERT (ELASTIC) STOP NUTS

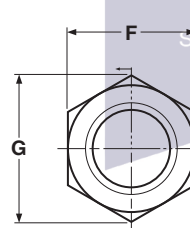
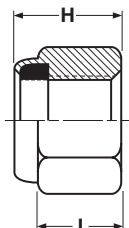

NYLON INSERT STOP NUTS, LIGHT HEX, THIN HEIGHT

Esna®

| Nominal Size or Basic Thread Diameter | | Esna® Part Numbers | | F | | | H | | I | G |
|---------------------------------------|--------|--------------------|-----------|--------------------|-------|-------|-----------|-------|-------------|----------------------|
| | | Steel, Zinc-plated | | Width Across Flats | | | Thickness | | Side Height | Width Across Corners |
| | | Coarse | Fine | Basic | Max | Min | Max | Min | Ref | Ref |
| | | | | | | | | | | |
| 2 | 0.0860 | 21NTM-26 | -- | 1/4 | 0.251 | 0.243 | 0.124 | 0.094 | 0.075 | 0.268 |
| 4 | 0.1120 | 21NTM-40 | -- | 1/4 | 0.251 | 0.243 | 0.124 | 0.094 | 0.075 | 0.268 |
| 6 | 0.1380 | 21NTM-62 | -- | 5/16 | 0.313 | 0.305 | 0.140 | 0.110 | 0.090 | 0.339 |
| 8 | 0.1640 | 21NTM-82 | -- | 11/32 | 0.345 | 0.336 | 0.187 | 0.157 | 0.110 | 0.374 |
| 10 | 0.1900 | 21NTM-04 | 21NTM-02 | 3/8 | 0.376 | 0.367 | 0.187 | 0.157 | 0.110 | 0.410 |
| 12 | 0.2160 | 21NTM-124 | -- | 7/16 | 0.439 | 0.430 | 0.218 | 0.188 | 0.125 | 0.482 |
| 1/4 | 0.2500 | 21NTE-040 | 21NTE-048 | 7/16 | 0.439 | 0.430 | 0.218 | 0.188 | 0.125 | 0.482 |
| 5/16 | 0.3125 | 21NTE-058 | 21NTE-054 | 1/2 | 0.502 | 0.492 | 0.265 | 0.235 | 0.158 | 0.552 |
| 3/8 | 0.3750 | 21NTE-066 | 21NTE-064 | 9/16 | 0.564 | 0.553 | 0.281 | 0.251 | 0.150 | 0.622 |
| 7/16 | 0.4375 | 21NTE-074 | 21NTE-070 | 5/8 | 0.627 | 0.615 | 0.328 | 0.298 | 0.225 | 0.694 |
| 1/2 | 0.5000 | 21NTE-083 | 21NTE-080 | 3/4 | 0.752 | 0.741 | 0.328 | 0.298 | 0.190 | 0.837 |
| 9/16 | 0.5625 | -- | 21NTE-098 | 7/8 | 0.877 | 0.865 | 0.374 | 0.344 | 0.225 | 0.978 |
| 5/8 | 0.6250 | 21NTE-101 | 21NTE-108 | 15/16 | 0.940 | 0.928 | 0.406 | 0.376 | 0.265 | 1.051 |
| 3/4 | 0.7500 | 41NTE-120 | 41NTE-126 | 1-1/8 | 1.064 | 1.052 | 0.421 | 0.391 | 0.288 | 1.191 |
| 7/8 | 0.8750 | 41NTE-144 | -- | 1-1/4 | 1.252 | 1.239 | 0.484 | 0.454 | 0.340 | 1.403 |
| 1 | 1.0000 | 41NTE-164 | -- | 1-7/16 | 1.440 | 1.427 | 0.578 | 0.516 | 0.405 | 1.615 |

| | | |
|---------------------------------|--|--|
| Description | Identical to a standard pattern nylon-insert stop nut but not as thick from top to bottom. | |
| Applications/ Advantages | Same general applications as the standard pattern, but thin pattern nuts are used when an insufficient number of projecting threads are present to use a standard nylon insert nut. | |
| Material | <i>Steel</i> | <i>Stainless</i> |
| | #4 through 5/8" diameters: AISI 1008 - 1010 or equivalent steel. 3/4" diameter: AISI C1117 or equivalent steel. | 18-8: Type 303 or equivalent stainless steel |
| Hardness | Rockwell C 28 maximum | 1/4 through 5/8: Rockwell B95 - C32; 3/4 through 1-1/2": Rockwell B80 - C32 |
| Proof Load | Thin pattern nylon insert nuts are intended for use in limited clearance applications and not for load bearing purposes. If a precise engineering standard is required, parts should be laboratory tested. | |
| Plating | Steel nylon insert stop nuts are usually supplied with a zinc plating. | Stainless nylon insert stop nuts are usually provided without any additional plating. |

Esna® is a registered trademark of the MacLean-Fogg Company. Kanebridge's stop nuts are not manufactured by or connected with the producers of Esna® nuts.