

# Rivets

## Stainless Rivet/Steel Mandrel

Dome Head  
Blind Rivet

SUPPLY CORP.

est. / 1946

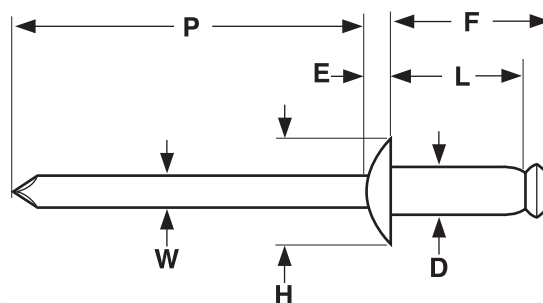

### DOME HEAD BREAK-STEM BLIND RIVETS

SAE J-1200

Nominal Rivet Diameter	D		H		E	W	P	F
	Rivet Shank Diameter		Head Diameter		Head Height	Mandrel Diameter	Mandrel Protrusion	Blind Side Protrusion
	Max	Min	Max	Min	Max	Nom	Min	Max
1/8	.128	.122	.262	.238	.040	.076	1.00	L + 0.120
5/32	.159	.153	.328	.296	.050	.095	1.06	L + 0.140
3/16	.191	.183	.394	.356	.060	.114	1.06	L + 0.160
1/4	.255	.246	.525	.475	.080	.151	1.25	L + 0.180

<b>Description</b>	A blind fastener with a self-contained carbon steel mandrel which permits the formation of an upset on the blind end of the rivet and expansion of the rivet shank during rivet setting. The steel mandrel is pulled into or against the rivet body, breaking at or near the junction of the mandrel shank and its upset end. The head of the rivet body is slightly rounded and twice as wide as the body diameter.
<b>Applications/Advantages</b>	The dome head style offers a low profile and a neat, finished appearance. Stainless rivets offer both corrosion resistance as well as high shear and tensile values. The stainless rivet body/steel mandrel combination is usually less expensive than the all stainless rivet.
<b>Material</b>	<b>Rivet Body:</b> 300-series stainless <b>Mandrel:</b> Carbon steel
<b>Shear Strength (Min.)</b>	1/8: 420 lbs.; 5/32: 650 lbs.; 3/16: 950 lbs.; 1/4: 1700 lbs
<b>Tensile Strength (Min.)</b>	1/8: 530 lbs.; 5/32: 820 lbs.; 3/16: 1200 lbs.; 1/4: 2100 lbs
<b>Mandrel Break Load</b>	1/8: 650 - 950 lbs.; 5/32: 1150 - 1450 lbs.; 3/16: 1400 - 1900 lbs.; 1/4: 3000 - 3600 lbs