

Trim Head

Self-Drilling

Self-Tapping Screws

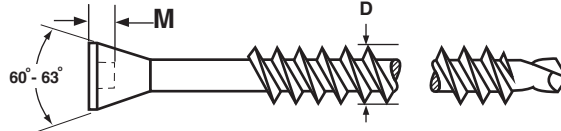
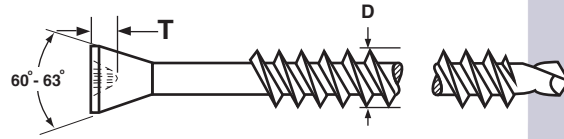
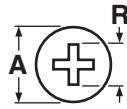

SUPPLY CORP.

est. / 1946

Jet FITTING

TRIM HEAD SELF DRILLING SCREWS

| Nominal Size & Number of Threads per Inch | D | | R | | T | | S | | M | | A | | Phillips Driver Size | Square Recess Driver Size | Torque Test (KG/CM) |
|---|-----------------------|------|-----------------|------|---------------------------------|------|---------------|------|--------------|------|---------------|--------|----------------------|---------------------------|---------------------|
| | Major Thread Diameter | | Recess Diameter | | Recess Penetration Gaging Depth | | Recess Square | | Recess Depth | | Head Diameter | | | | |
| | Max | Min | Max | Min | Max | Min | Max | Min | Max | Min | Max | Min | | | Min |
| 6-20 | .142 | .133 | .136 | .121 | .082 | .066 | .091 | .089 | .063 | .047 | .236 | .216 | 1 | 1R | 28 |
| 8-18 | .169 | .161 | .136 | .121 | .082 | .066 | .091 | .089 | .063 | .047 | .275 | .255 | 1 | 1R | 45 |
| 8-18 | .169 | .161 | .182 | .168 | .104 | .079 | .113 | .110 | .075 | .060 | .275 | .255 | 2 | 2R | 45 |
| 10-16 | .189 | .182 | .182 | .168 | .110 | .086 | .113 | .110 | .075 | .060 | .331 | .291 | 2 | 2R | 70 |
| 14-14 | .246 | .240 | - | - | - | - | .135 | .131 | .095 | .080 | .362 | .333 | - | 3R | - |
| Tolerance on Length | | | | | | | | | | | | ± 0.06 | | | |

SUPPLY CORP.

est. / 1946

| | |
|--|---|
| Description | A steel fastener with a spaced thread, a point that drills its own hole, and a countersunk flat head of a width 1/3 less than a standard self drilling screw. |
| Applications/ Advantages | Ideal for attaching base board or trim through one or two layers of drywall to 12 - 20 gauge metal studs: |
| Material | AISI 1016 - 1022 or equivalent steel. |
| Heat Treatment | Screws shall be quenched in liquid and then tempered by reheating to 625°F minimum. |
| Surface Hardness | Vickers HV 550 - 800 |
| Case Depth | .004 minimum |
| Core Hardness (after tempering) | Vickers HV 270 - 450 |
| Plating | Trim head self-drilling screws are commonly available in zinc plated coatings. See Appendix-A for details. |

est. / 1946