

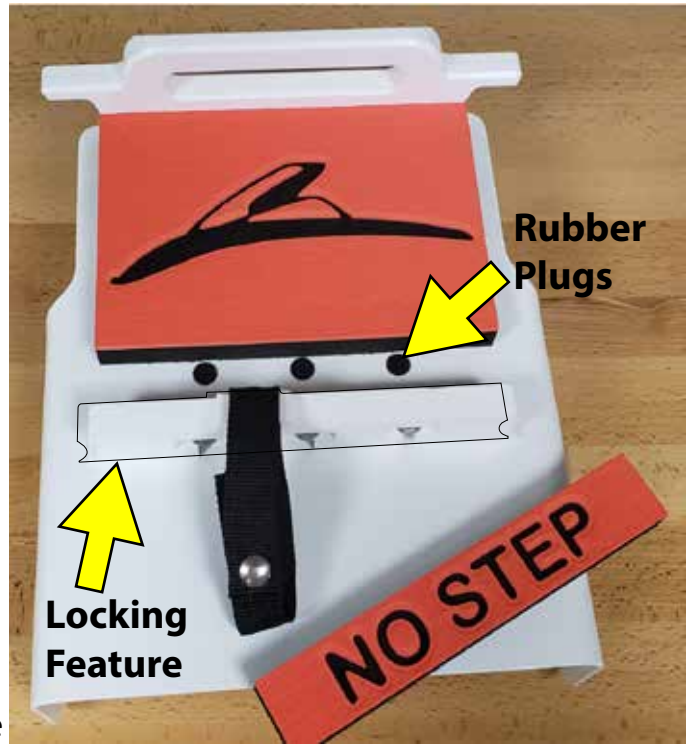

# JETWASH DEFLECTOR ASSEMBLY



Your JetWash Deflector has been partially pre-assembled. To complete the assembly first measure the distance from the ladder's horizontal frame rail to the top of the upper rung. If the dimension is 8 5/8" prep the surface above locking feature with acetone & install the "No Step" pad. If the dimension is 7 1/8" you will need to relocate the locking feature (shown above) from its current location to the upper location & **insert the rubber plugs in the lower holes**. Then prep the surface & install "No Step" pad as shown (lower right).

**8 5/8"**  
**Inches**

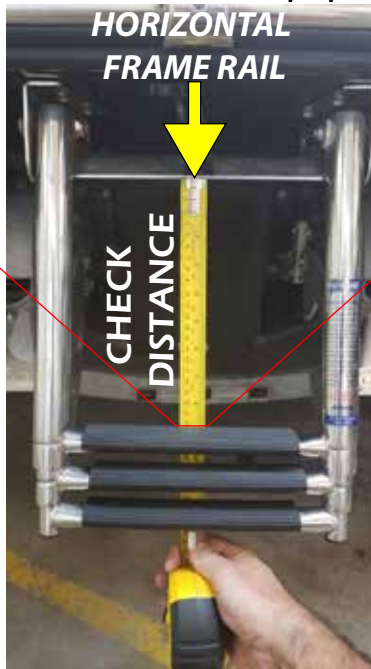
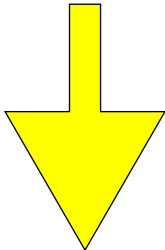

**7 1/8"**  
**Inches**

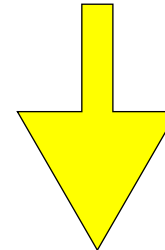

Most Yamaha Ladders 2009-Current



Most Yamaha Ladders 2003-2008