



RHINO-RACK

Chevrolet Colorado & GMC Canyon QMFK Supplement

Important: Please read these instructions carefully prior to and during installation.
Check the contents of kit before commencing fitment and report any discrepancies.

Rhino-Rack
3 Pike Street, Rydalmere,
NSW 2116, Australia.
(Ph) (02) 9638 4744
(Fax) (02) 9638 4822

Document No: R889
Prepared By: Kayle Everett
Authorised By: Chris Murty

Fit Time: 1 Hour
Issue No: 04
Issue Date: 17/06/16

These instructions remain the property of Rhino-Rack Australia Pty. Ltd. and may not be used or changed for any other purpose than intended.

Parts List

Item	Components	VA Qty	HD	Part No.
1	Vortex Crossbar	2	-	VA126S/B
2	Heavy Duty Crossbars	-	2	RB1250S/B
3	Quick Mount Roof Ditch Bracket	2	2	QMFK08
4*	Quick Mount Base Wedge 5mm	1	1	QMW05
5*	Quick Mount Base Wedge 10mm	1	1	QMW10
6	Quick Mount HD Spacer 5mm	-	2	QMHD05
7	Leg and Base Kit	1	1	RLT600
8	Fitting Instructions	1	1	R889

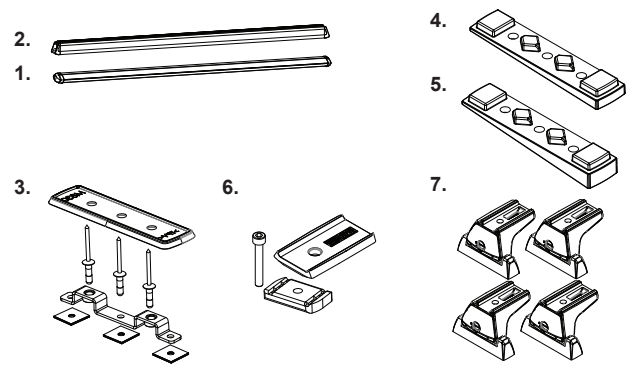

Note:

All 4 kits are sold as separate.
Ensure you have the required kits to complete your fitment.

Tools Required:

- Masking tape
- Marking Pen
- Clevis Hook
- Cold galvanising paint

- Ø5-6mm Drill stop
- Cotton buds
- Tape measure
- Power Drill
- 5mm drill bit

- Pneumatic Rivet Gun
- Angle grinder with cut off wheel

*Use with Pioneer Fitment

Instructions

1 Starting at the rear of the vehicle, carefully lift the Ditch Mold.

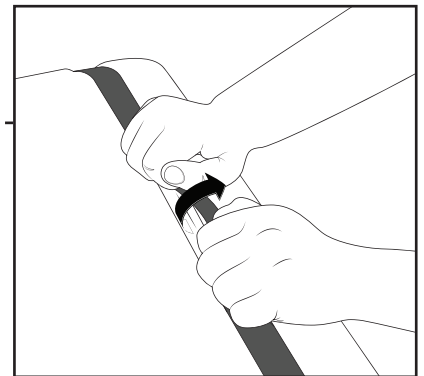
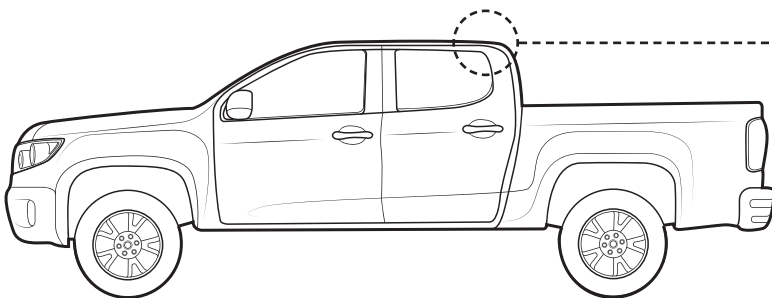

2 There are three Pip Studs holding the Ditch Mold in place. Using a Clevis Hook or similar tool, carefully flex the Track Stud Housing over the Pip Studs. Remove the Ditch Mold from the Roof.

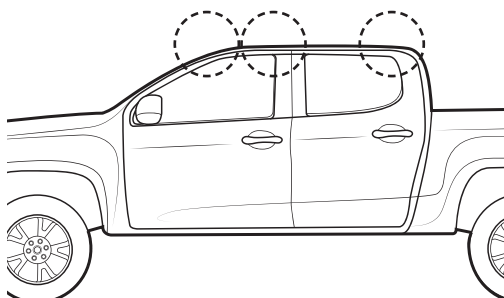

Side View: Hook the Stud Housing on the Track as shown. Care is needed as to not damage the body work of the vehicle.

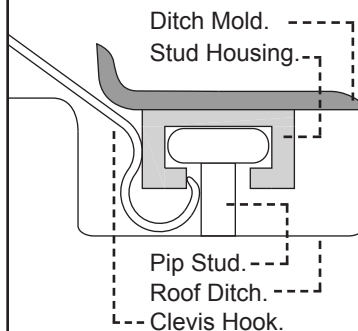

Side View: Carefully flex the Stud Housing over the Pip Stud. Complete this step for each Pip to release the Ditch Mold.

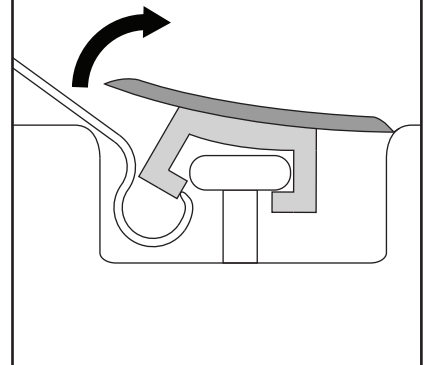



Chevrolet Colorado & GMC Canyon QMFK Supplement

3 Measure 120mm/ 4.72" from the Pip Stud at the rear of the vehicle. Place the QMFK Bracket into the Ditch here. The Centre hole of the Bracket should sit at this measurement. Measure forward from this centre point 850mm/ 33.46" and place another Bracket here in the same fashion. With a drill bit, mark each of the three rivet holes. Use a Drill Bit to spot mark all Rivet Holes in the Bracket as shown. Be sure the Brackets are parallel on both sides.

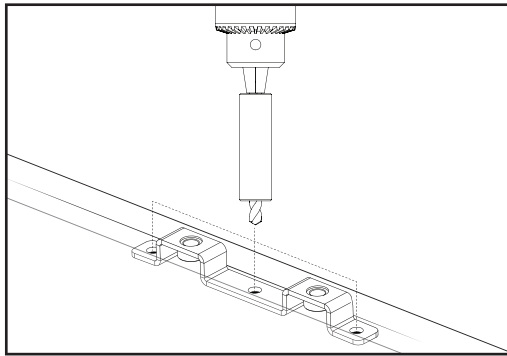

Rear of vehicle.

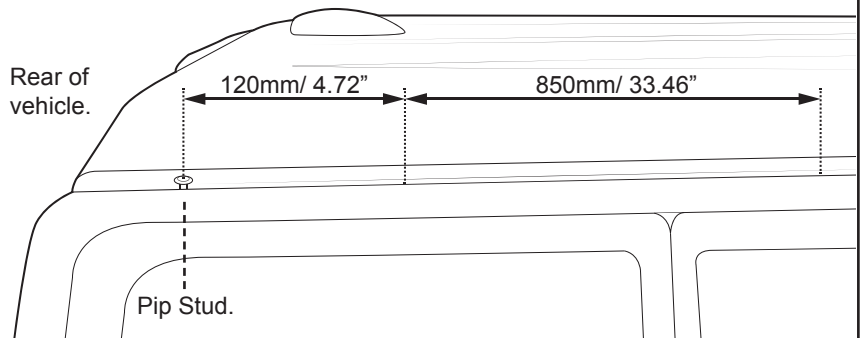

4 Drill out all marked holes with a 5mm Drill Bit. Use a Drill Stop set to 5mm-7mm.

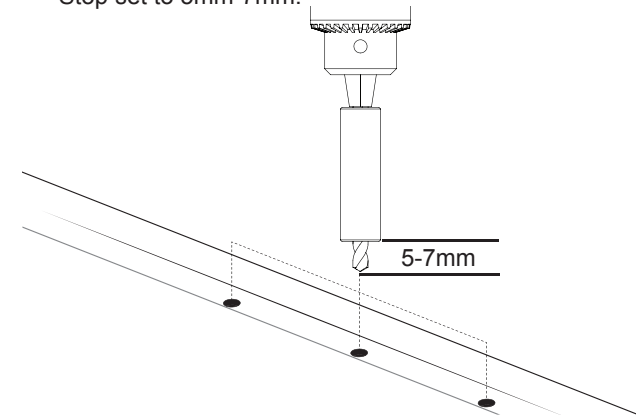

5 Vacuum and swarf from the roof ditch.

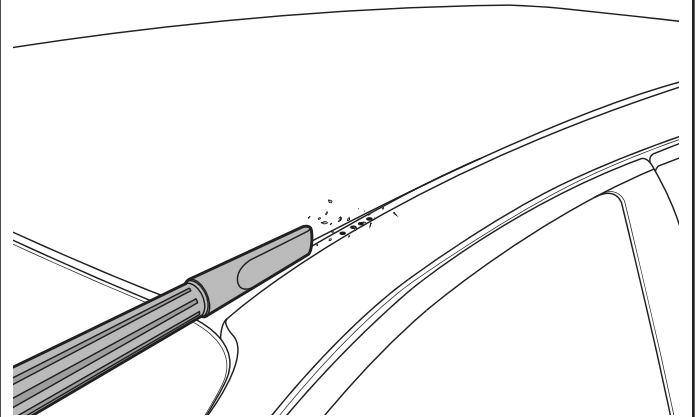

6 Using Cold Galvanising Paint, cover all drilled areas and any exposed body work.

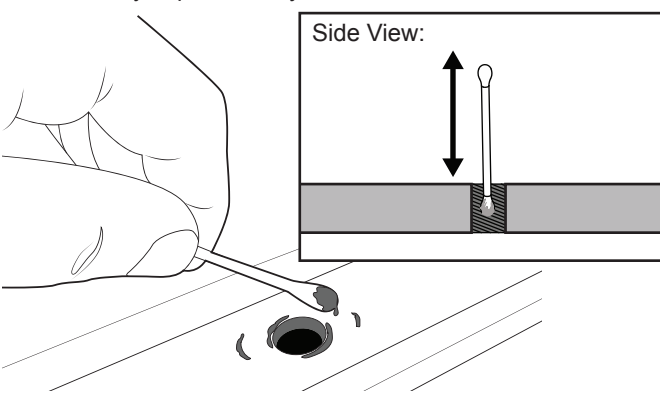

7 Peel off the one side of backing tape on the Butyl Patches provided. Place these carefully over all holes drilled. Remove the top layer of backing tape as shown.

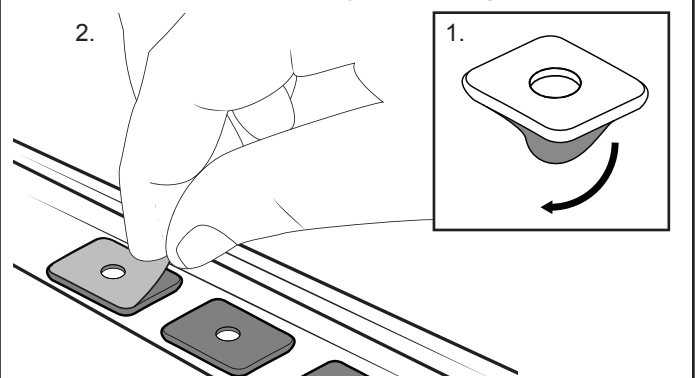

8 Press the Ditch Brackets into position over the drilled holes. Using a Pneumatic Rivet Gun, fix the Brackets in place with Rivets provided. Be sure Brackets are aligned correctly.

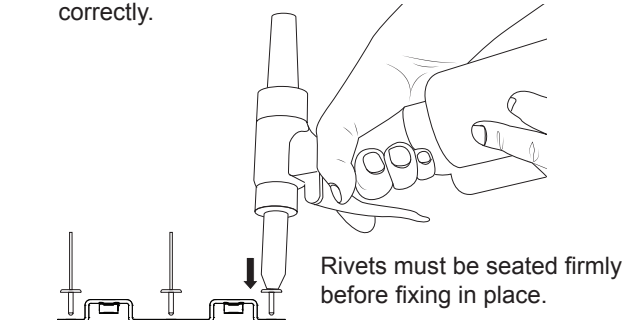

Rivets must be seated firmly before fixing in place.

9 Install leg kits as per corresponding instructions.

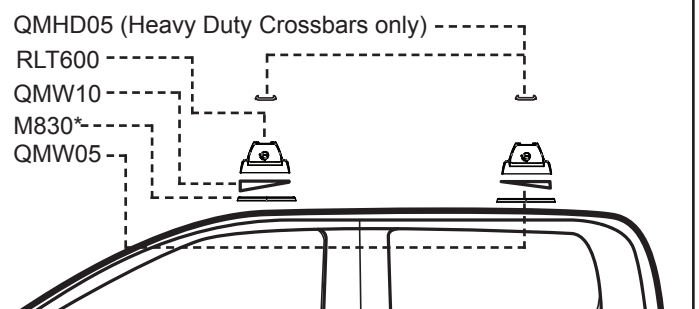

*M830 will sit on top of the installed Bracket and is optional. The Gasket will cover exposed areas of the Bracket and Ditch Mould. QMW05/10 used when fitting Pioneer Tray.